

*** Outline Dimension(mm)**

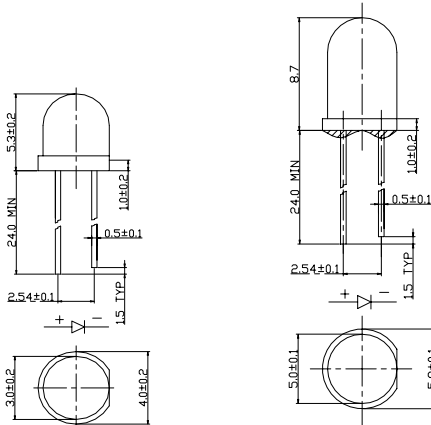

NOTES: 1. ALL DIMENSIONS ARE IN mm , TOLERANCE IS +/-0.25, UNLESS OTHERWISE NOTED.
 2. AN EPOXY MENISCUS MAY EXTEND ABOUT 1.5mm DOWN THE LEADS.
 3. BURR AROUND BOTTOM OF EPOXY MAY BE 0.5mm MAX.

NOTES: 1. ALL DIMENSIONS ARE IN mm , TOLERANCE IS +/-0.25, UNLESS OTHERWISE NOTED.
 2. AN EPOXY MENISCUS MAY EXTEND ABOUT 1.5mm DOWN THE LEADS.
 3. BURR AROUND BOTTOM OF EPOXY MAY BE 0.5mm MAX.

*** Far Field Pattern**

50% Power Angle : 45°

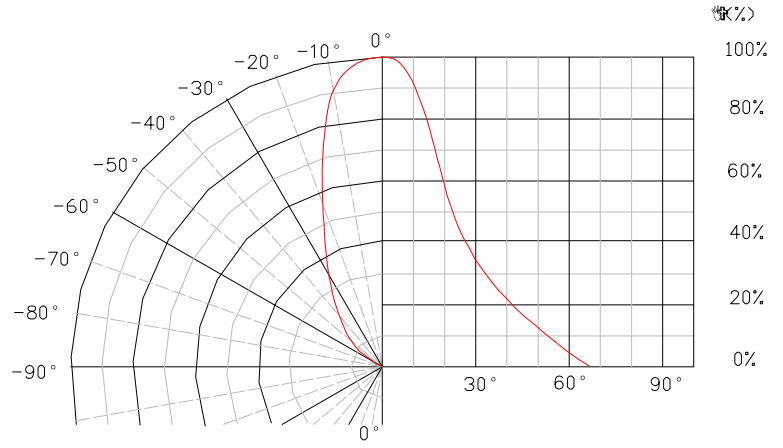

FAR FIELD PATTERN

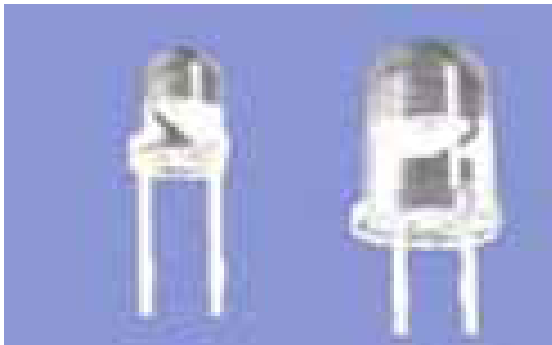

.Features

- . High intensity
- . Reliable and rugged
- . I.C. compatible.
- . Low power emission

.Application

- . Infrared LED for photo sensor.
- . Remote control system optical switch.

Part NO.	Viewing Angle (deg)	Size	Lens Color	Chip		Radiant Intensity I _E (mW/Sr) (IF=20mA)		V _f (V) (IF=20mA)	
				Material	λD(nm)(IF=20mA)	Min	Typ	Typ	Max
WCN-301IN1-45N	22	3mm	Water Clear	GaAlAs/GaAs	940		20	1.35	1.60
WCN-501IN1-45N	30	5mm	Water Clear	GaAlAs/GaAs	940		25	1.35	1.60